

# Section 1007.6 Areas of Refuge

**1007.6 Areas of refuge.** Every required area of refuge shall be accessible from the space it serves by an accessible means of egress. The maximum travel distance from any accessible space to an area of refuge shall not exceed the travel distance permitted for the occupancy in accordance with Section 1016.1. Every required area of refuge shall have direct access to a stairway within an exit enclosure complying with Sections 1007.3 and 1022 or an elevator complying with Section 1007.4. Where an elevator lobby is used as an area of refuge, the shaft and lobby shall comply with Section 1022.9 for smokeproof enclosures except where the elevators are in an area of refuge formed by a horizontal exit or smoke barrier.

**Exceptions:**

1. A stairway serving an area of refuge is not required to be enclosed where permitted in Sections 1016.1 and 1022.1.
2. A smokeproof enclosure is not required for an elevator lobby used as an area of refuge where the elevator is not required to be enclosed.

**Q:** When two accessible means of egress are required from a floor, can providing a single horizontal exit serve to establish both required accessible means of egress, with one “area of refuge” provided on each side of the horizontal exit? The concept is demonstrated by Figure 10-26. We have also understood that each accessible portion of a building must have two accessible means of egress available to it. Therefore, must there be an additional area of refuge next to the stairway provided on each side of the horizontal exit, such that each accessible space (each side of the horizontal exit) is provided with two accessible exits?

**A:** When a horizontal exit is incorporated into a building, the intent of the code is that the portion of the building occurring on one side of the horizontal exit “wall” serves as a refuge area for the other side of the wall that is separated by the horizontal exit. Thus Figure 10-26 accurately reflects the requirement, and an additional area of refuge is not needed at each stairway. [10-26]

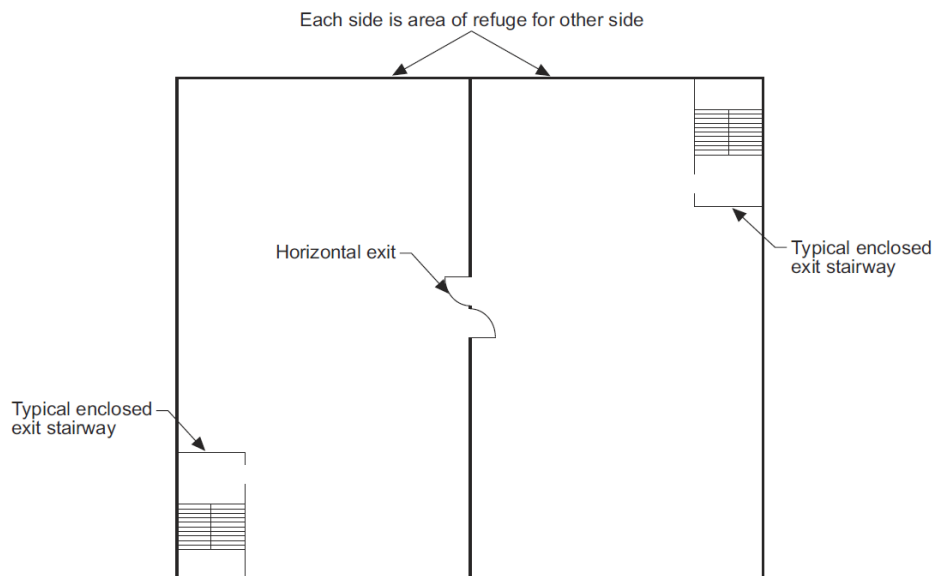

**Figure 10-26**