

# Table R301.5

## Minimum Uniformly Distributed Live Loads

**CHANGE TYPE:** Modification

**CHANGE SUMMARY:** The terminology related to live loads has been updated for consistency with ASCE 7-10. Footnotes b and g pertaining to attic live loads have been revised to clarify the application.

**2012 CODE:**

**TABLE R301.5** Minimum Uniformly Distributed Live Loads (in pounds per square foot)

Use	Live Load
Uninhabitable attics without storage <sup>b</sup>	10
Uninhabitable attics with limited storage <sup>b,g</sup>	20
Habitable attics and attics served with fixed stairs	30

[No change to portions of table not shown]

- a. [No change to text]
- b. Uninhabitable attics without storage are those where the maximum clear height between joists and rafters is less than 42 inches, or where there are not two or more adjacent trusses with ~~the same~~ web configurations capable of ~~containing a~~ accommodating an assumed rectangle 42 inches high in height by 2 feet wide 24 inches in width, or greater, ~~located within the plane of the trusses.~~ For attics without storage, This live load need not be assumed to act concurrently with any other live load requirements.
- c. through f. [No change to text]
- g. For Uninhabitable attics with limited storage ~~and constructed with trusses, this live load need be applied only to those portions of the bottom chord are those where the maximum clear height between joists and rafters is 42 inches or greater, or where there are two or more adjacent trusses with the same web configurations capable of containing~~ accommodating a an assumed rectangle 42 inches high in height or greater by 2 feet wide 24 inches in width, or greater, ~~located within the plane of the trusses. The rectangle shall fit between the top of the bottom chord and the bottom of any other truss member, provided that each of the following criteria is met.~~

The live load need only be applied to those portions of the joists or truss bottom chords where all of the following conditions are met:

1. The attic area is accessible by a ~~pull-down stairway or framed in accordance with Section R807.4 from an opening not less than 20 inches in width by 30 inches in~~ length that is located where the clear height in the attic is a minimum of 30 inches.
2. The ~~slopes of the joists or truss has a bottom chords pitch less than 2:12 are no~~ greater than 2 units vertical to 12 units horizontal.
3. Required insulation depth is less than the ~~joist or truss~~ bottom chord member depth.

The ~~remaining portions of the joists or truss bottom chords of trusses meeting the above criteria for limited storage shall be designed for the greater of the actual imposed dead load or 10 psf; a uniformly distributed over the entire span concurrent live load of not less than 10 lb/ft<sup>2</sup>.~~

- h. [No change to text]

**CHANGE SIGNIFICANCE:** Attics other than habitable attics are now labeled uninhabitable attics for consistency with the 2010 edition of the ASCE 7 standard. An extensive rewrite of footnotes b and g, though mostly editorial, clarifies the intent of provisions for determining when an uninhabitable attic must be designed for a minimum live load of 20 psf for limited storage. For trusses, the determination is still based on a 24-inch-by-42-inch rectangle, but the text is changed to describe an assumed condition rather than an actual one, which is considered more appropriate for a building code requirement. The addition of joists and

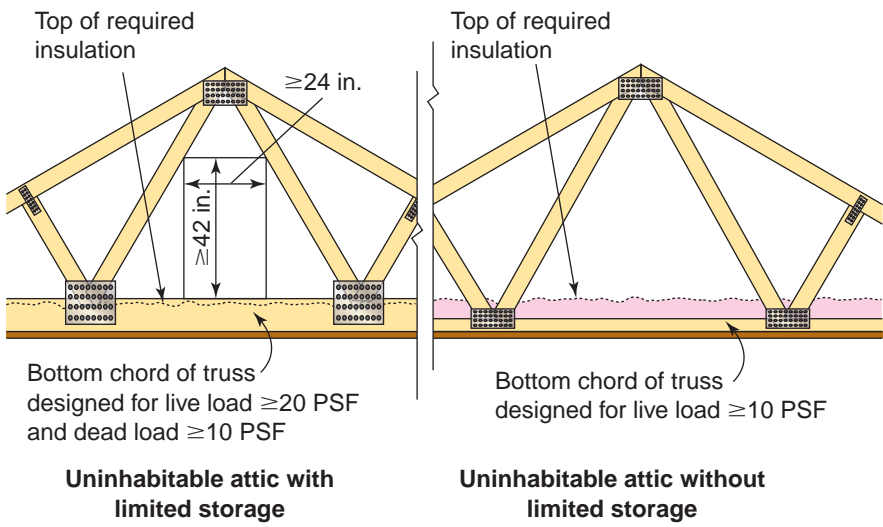
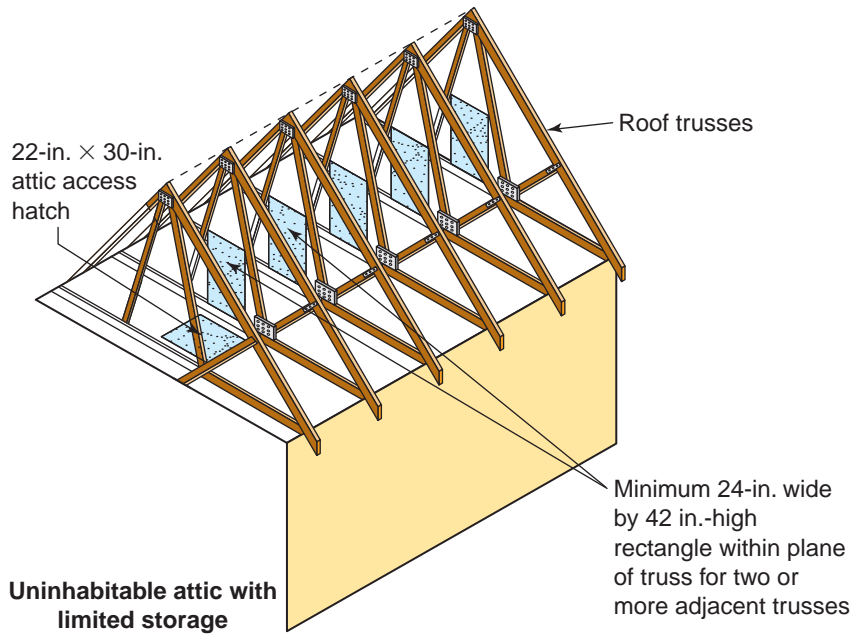

International Code Council®

Minimum uniformly distributed live loads for attic trusses.



Uninhabitable attic with limited storage.

rafters to the footnotes recognizes that a determination for minimum loading is required for attics constructed of conventional wood framing as well as those constructed with trusses.

The references to a pull-down stairway and Section R807.1 in item 1 of footnote g are replaced with minimum attic access opening dimensions of 20 inches by 30 inches. However, Section R807.1 requires a minimum attic access opening of 22 inches by 30 inches for attics of combustible construction that have a minimum vertical dimension of 30 inches. Only habitable attics and attics served by fixed stairs require a live load of 30 psf. If fixed stairs are not provided, uninhabitable attics meeting the criteria for limited storage, including access through a 22-inch by 30-inch opening, must support a minimum live load of 20 psf, whether or not a pull-down stairway is provided.