

## Height above finished grade

The IRC intends to protect the building from moisture intrusion that may damage portions of the structure and cause an unhealthy living environment. As part of these requirements, concrete and masonry foundation walls must extend above the finished grade a minimum of 6 inches. Masonry veneer provides somewhat better protection against moisture intrusion at ground level than do siding and other exterior wall finishes, and the elevation requirement for the top of the foundation wall is reduced accordingly to 4 inches above finished grade (Figure 5-21). [Ref. R404.1.6]

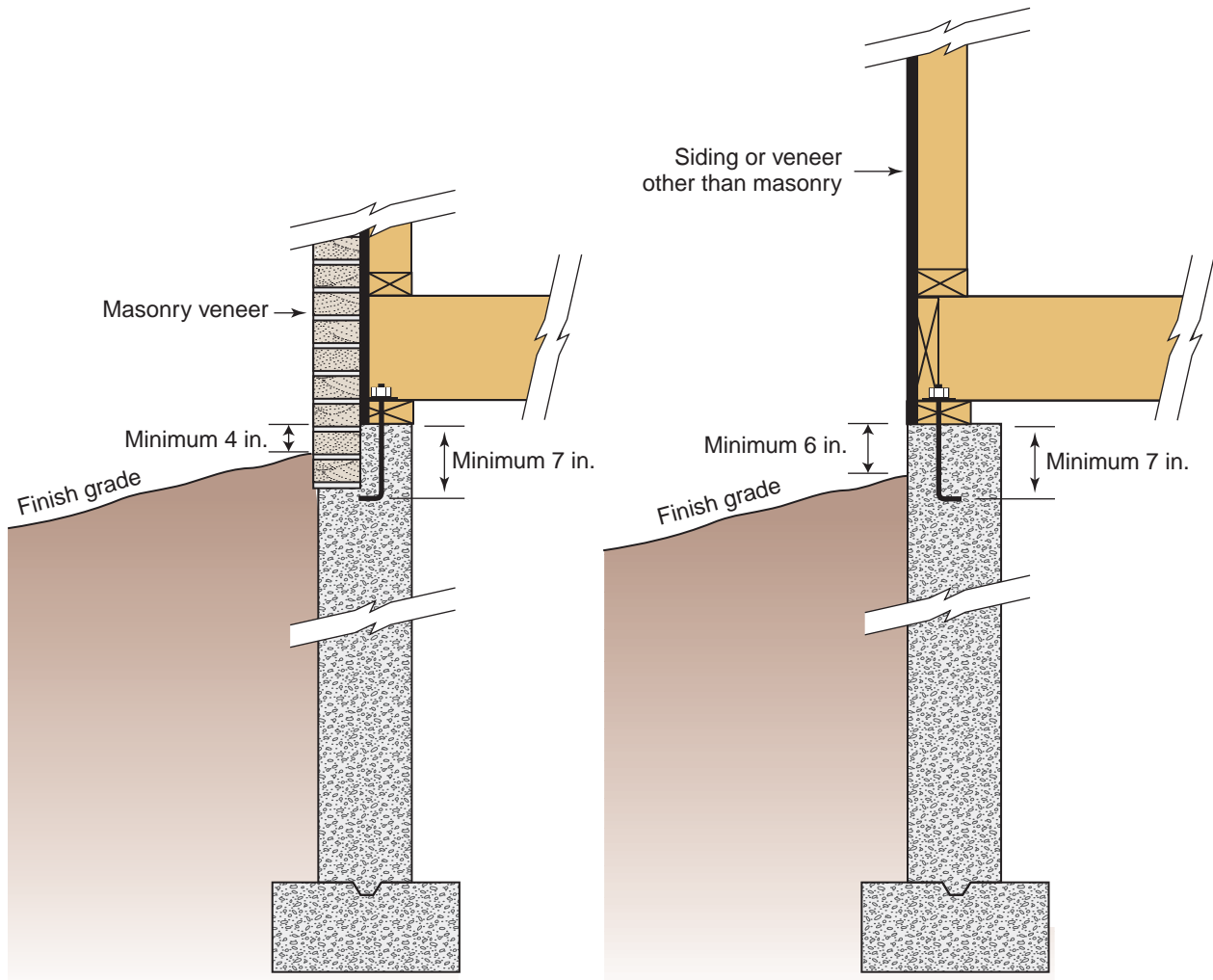

**FIGURE 5-21** Foundation height above finished grade